

end post thickness (mm)	length (m)	theoretical weight (kg)
2	2	4,44
	2,2	4,88
	2,4	5,33
2,5	2	5,55
	2,2	6,1
	2,4	6,66

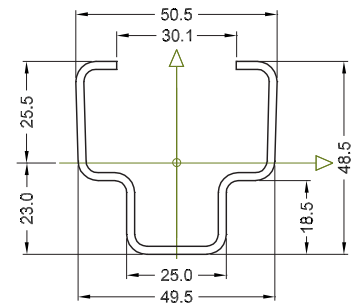

intermediate post thickness (mm)	length (m)	theoretical weight (kg)
1,5	1,8	2,43
	2	2,7
	2,2	2,97
1,8	1,8	2,91
	2	3,24
	2,2	3,56

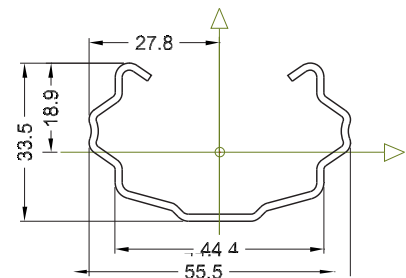

tables of wire calibres

Paris n°	diameter (mm)	m/kg	kg/100m
13	2	40,85	2,44
14	2,2	33,74	2,96
15	2,4	28,34	3,528
16	2,7	22,4	4,463
17	3	18,14	5,513